



Refrigerated and Dry Flat Glass Display Cases

KBF-36 | KBF-48 | KBF-60 | KBF-72
KBF-36D | KBF-48D | KBF-60D | KBF-72D



KBF-60

Durable Design

- Forced air, self-contained refrigerated merchandiser (for the refrigerated cases only)
- Modern design for merchandising beverages, cheese, sandwiches and much more
- Exterior and interior tempered safety glasses (Double layer glass is tempered glass)
- 2 Removable rear sliding glass doors (but KBF-72:4 doors)
- Designed for mobility, reliability & efficiency in commercial kitchens
- (2) Height Adjustable shelves
- Slide out condensing unit for easy maintenance
- KBF-36, KBF-48: 4 casters, KBF-60: 5 casters, KBF-72: 6 casters
- Simple plug-in installation

Superior Quality

- Stainless steel lower body panels
- Solid body construction
- Certified to ETL safety and sanitation standards
- With R290 refrigerant

Energy Efficient

- Digital temperature readout display with electronic thermostatic control
- Double layer glass for front and sides and back (there is NO film heaters inside of the glass)
- LED lighting at top & under shelves & on base back and front
- Automatic defrost system
- Automatic self-closing doors
- Case holds 36°F - 41°F



Introducing the Kool-It KBF Refrigerated and Dry Flat Glass Display Cases, where modern design meets functionality to elevate your merchandising experience. Whether you're showcasing chilled beverages, tempting desserts, savory sandwiches, or any other delicacies, the Kool-It KBF Flat is the ultimate solution for stylish merchandising.



Intertek Intertek

Warranty: 12 months parts and labor. *Additional 48 months on compressor (part only)
KOOL-IT is a registered trademark of MVP Group. Specifications subject to change without notice.
The refrigerated KBF series cases are engineered to operate in locations not exceeding 80°F and 55%



www.mvpgroupcorp.com



3560 NW 56th Street
Fort Lauderdale, FL 33309
Tel.: 786.600.4687 / Toll Free: 844.218.8477



5659 Royalmount Avenue
Montreal, Qc, Canada H4P 2P9
Tel.: 514.737.9701 / Toll Free: 888.275.4538

sales@mvpgroupcorp.com



Refrigerated and Dry Flat Glass Display Cases

KBF-36 | KBF-48 | KBF-60 | KBF-72
KBF-36D | KBF-48D | KBF-60D | KBF-72D

KBF-36
KBF-36D

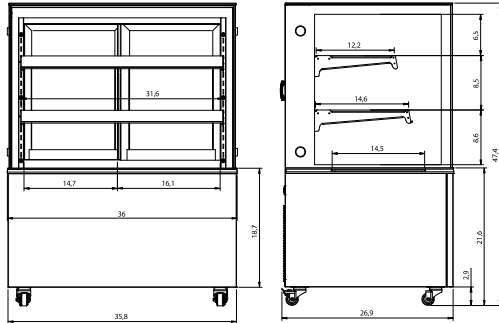
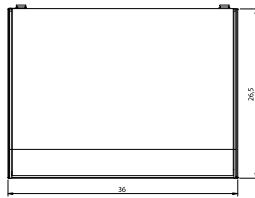

KBF-48
KBF-48D

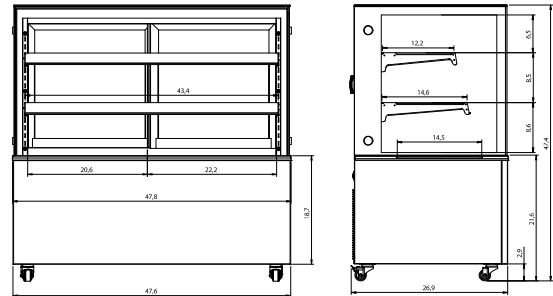
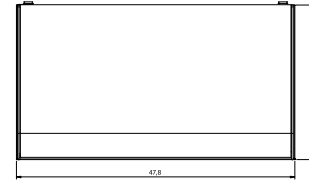

KBF-60
KBF-60D

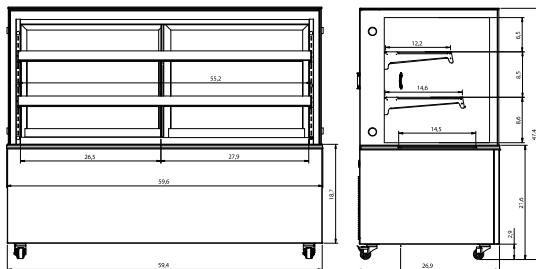
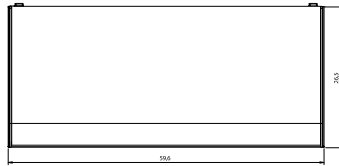

KBF-72
KBF-72D

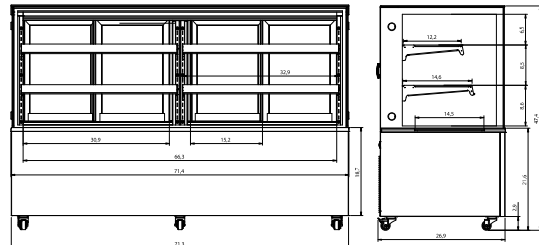
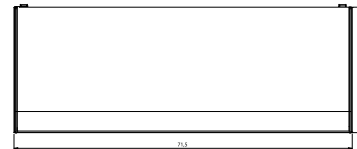

MODEL	CAPACITY (Cubic feet)	VOLTAGE	AMPS	COMPRESSOR	EXTERNAL DIMENSIONS (W x D x H)	SHIPPING DIMENSIONS (W x D x H)	SHIP WEIGHT (LBS)
KBF-36	10.4	110-120/60/1	3.7	1/3	36" x 26.6" x 47.6"	39.4" x 29.3" x 50"	364
KBF-48	14.1	110-120/60/1	3.7	1/3	47.8" x 26.6" x 47.6"	51.2" x 29.3" x 50"	432
KBF-60	18	110-120/60/1	4	1/3	59.6" x 26.6" x 47.6"	63" x 29.3" x 50"	518
KBF-72	21.5	110-120/60/1	7.5	1/3	71.5" x 26.6" x 47.6"	74.8" x 29.3" x 50"	542
KBF-36D	10.4	110-120/60/1	0.2	N/A	36" x 26.6" x 47.6"	39.4" x 29.3" x 50"	300
KBF-48D	14.1	110-120/60/1	0.3	N/A	47.8" x 26.6" x 47.6"	51.2" x 29.3" x 50"	384
KBF-60D	18	110-120/60/1	0.3	N/A	59.6" x 26.6" x 47.6"	63" x 29.3" x 50"	471
KBF-72D	21.5	110-120/60/1	0.3	N/A	71.5" x 26.6" x 47.6"	74.8" x 29.3" x 50"	476